

City of Muscatine IA 92 Pavement History

1983 2.5" BAC - width varies
1937 7.5" PCC Paving - width varies 40' - 50'

2010 10.0" PCC - width varies, 8" granular base course
Pavement Replacement as part of City sanitary storm sewer project
Permit 70U-2009-003: Contract Plans prepared by Stanley Consultants
8/6/2009

1972 9.0" PCC Paving -

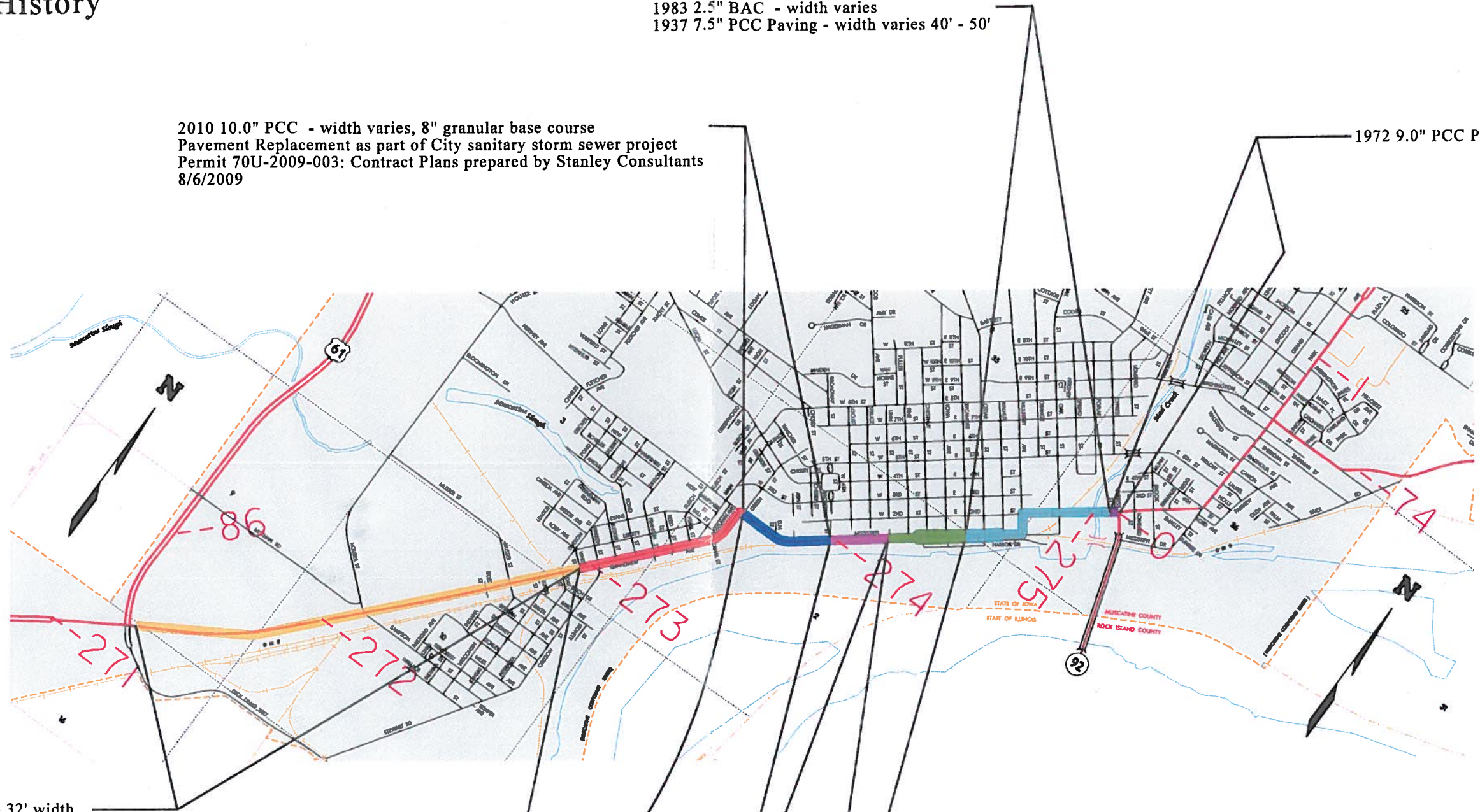







2010 3.0" HMA Overlay - 32' width
2.0" Scarification - 32' width
Includes 4' paved shoulders
1973 4.5" BAC - 24' width
1930 7.0" PCC Paving - 18' width

2010 3.0" HMA Overlay - 45' width, curb and gutter
1998 2.0" Spot AAC Overlay -
2.0" Milling -
1986 3.0" BAC - 45' width
1951 10.0" PCC Paving - 45' width

1998 2.0" Spot AAC Overlay -
2.0" Milling -
1986 3.0" BAC - 45' width
1937 7.5" PCC Paving - 40' width

1998 2.0" Spot AAC Overlay -
2.0" Milling -
1983 4.5" BAC - width varies
1964 7.5" PCC Paving - width varies

			
Section 1 1.59 Miles	Section 2 0.63 Miles	Section 3 0.38 Miles	Section 4 0.19 Miles
			
Section 5 0.41 Miles	Section 6 0.55 Miles	Section 7 0.37 Miles	